

**GROUP 600
ACCESSORIES
MOD.
615B/124**

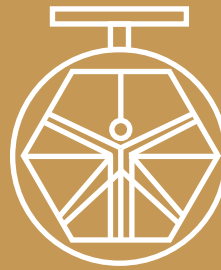

**DAVINCI
VALVES™**

**TECHNICAL
DATA SHEET
WATER Series**

DEDICATED COUPLING FOR DUCTILE IRON PIPE

**DAVINCI
VALVES™**



**QUALITY
ASSUREMENT**

**DAVINCI
VALVES™**



**PRODUCT QT
ASSUREMENT**

**DAVINCI
VALVES™**



**COMPANY QT
ASSUREMENT**

www.davincivalves.com

18 Dongyu Street, Square One,
11th Floor 1101, Jinjiang District,
Chengdu, Sichuan CHINA

10F/Tower A, Billion Center,
1 Wang Kwong Road, Kowloon Bay
Kowloon HONG KONG

DEDICATED COUPLING FOR DUCTILE IRON PIPE PN10/16/25 Ref.615B

APPLICATION:

Water, HVAC installations, irrigation, industry, others

STANDARDS:

Comply with EN545/ISO2531/EN1452

Pressure Test: EN 12266-1.

GENERAL CHARACTERISTICS:

Size DN50 to DN2000,

Powder Epoxy coating 250 Mic

WORKING CONDITIONS:

Working Temperature:

- 10 °C - + 120 °C. for EPDM

- 10 °C - + 82 °C. for NBR

Working pressure PN10/16/25

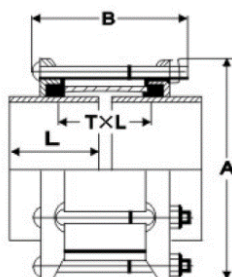

Name	Material
Body	GJS500
End ring	GJS500
Gasket	EPDM/NBR
Bolt	CS Dacromet
Washer	CS Dacromet
Nut	CS Dacromet

DN	OD Pipe	OD Tol	L	A	B	Sleeve		Plugs	BOLTS		Max Test pres	Kgs
mm	mm	in	mm	mm	mm	T mm	L mm	qty	Qty	DIA*L	Bar	Kgs
80	98	+2,1 / -2,6	100	178	168	7,1	102	1	4	1/2*160	70	5,6
100	118	+2,1 / -3,0	100	200	168	7,4	102	1	4	1/2*160	70	6,6
125	144	+2,3 / -3,0	100	230	168	7,5	102	1	4	1/2*160	62	8,4
150	170	+2,3 / -3,0	100	262	173	7,6	102	1	4	1/2*165	60	10,5
200	222	+2,4 / -3,5	100	314	173	7,6	102	1	6	1/2*165	58	14
250	274	+2,5 / -3,5	100	368	173	8	102	2	6	1/2*165	50	20,6
300	326	+2,6 / -3,5	100	420	173	8,5	102	2	6	1/2*165	50	22,2
350	378	+2,7 / -3,5	125	488	252	9,5	152	2	8	5/8*240	40	33
400	429	+2,8 / -4,0	125	539	252	9,5	152	2	8	5/8*240	38	38,4
450	480	+2,9 / -4,0	125	590	252	9,5	152	3	10	5/8*240	35	45,4
500	532	+3,0 / -4,0	125	642	252	9,5	152	3	10	5/8*240	35	56,7
600	635	+3,2 / -4,0	125	745	252	9,5	152	2	12	5/8*240	35	78,4
700	738	+3,4 / -4,5	125	848	252	9,5	152	3	12	5/8*240	30	93,8
800	842	+1,0 / -4,5	125	952	252	9,5	152	3	14	5/8*240	28	112,7
900	945	+1,0 / -5,0	150	1060	278	9,5	178	3	16	5/8*265	28	137,6
1000	1048	+1,0 / -5,0	150	1163	278	12	178	3	16	5/8*265	28	147
1100	1152	+1,0 / -6,0	150	1280	290	12	178	3	20	5/8*275	29	180
1200	1255	+1,0 / -6,0	150	1383	290	12	178	3	22	5/8*275	28	222,6
1400	1462	+1,0 / -7,0	150	1590	290	12	178	3	24	5/8*275	25	252,3
1500	1565	+1,0 / -7,0	150	1695	290	12	178	3	26	5/8*275	25	274
1600	1668	+1,0 / -7,0	150	1798	290	12	178	3	28	5/8*275	25	284,9
1800	1875	+1,0 / -7,0	200	2015	395	15	254	3	32	5/8*280	22	541,8
2000	2082	+1,0 / -8,0	200	2222	395	15	254	3	36	5/8*280	20	607

All the components can be substituted with equivalent or higher-class materials.

DAVINCI VALVES LTD, is constantly looking at all ways of improving our products and services related to the water, fire and industry sector and therefore we reserve the right to change, without prior notice, any of the data contained here. Please contact our Technical Sales Department for detailed advice.
© 2018 DAVINCI VALVES LTD.

"For professionals who wants more"



DAVINCI
VALVES™

www.davincivalves.com